

AURORA

29QBS

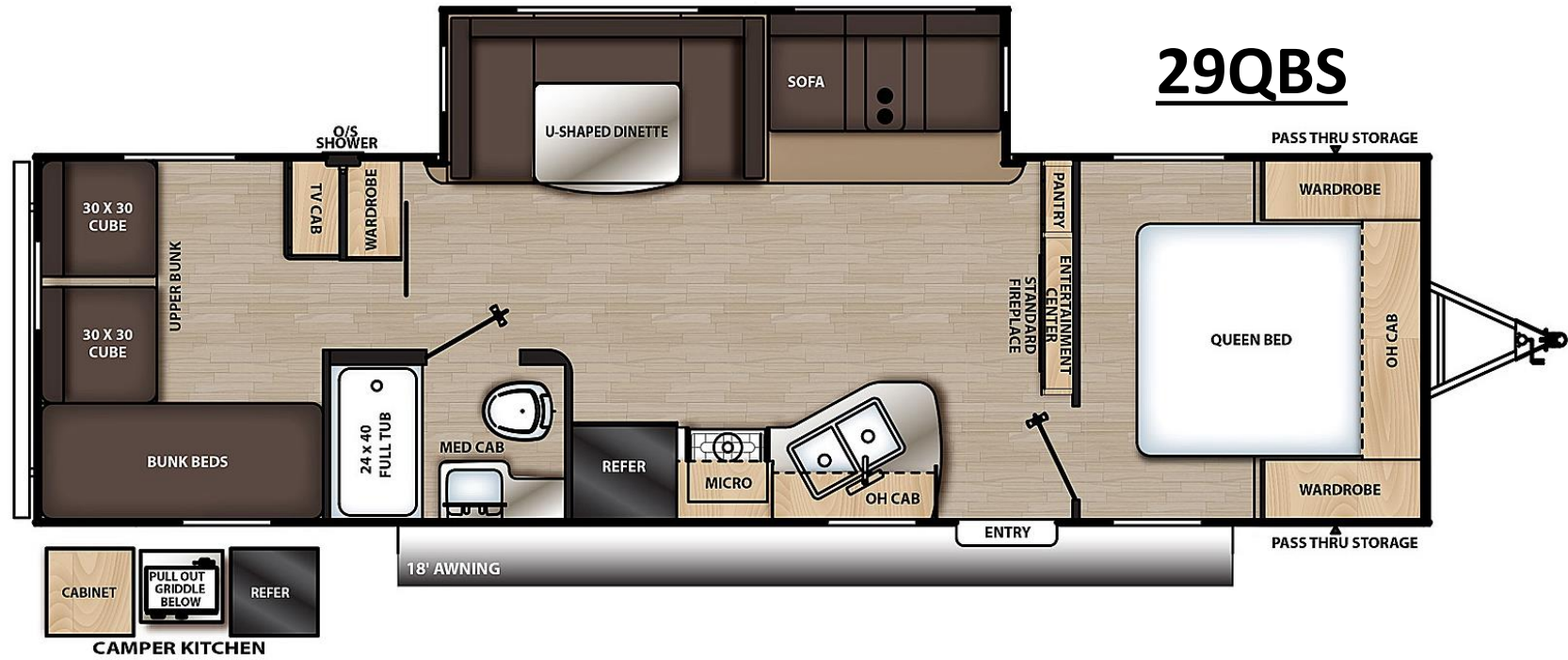

SPECIFICATIONS

UVW	GVWR:	CCC	Hitch Weight:	Ext. Length:	Ext. Height:	Ext. Width:	Fresh Water:	Gray Water:	Black Water:	Awning Size:
6849 lb.	9500 lb.	2651 lb.	768 lb.	32' 9"	11' 1"	96"	44 gal.	40 gal.	30 gal.	18'

Key Floor Plan Features:

- ✓ L-Style Bunk Room Sleeps 5+
- ✓ Standard Outside Camp Kitchen w/Griddle
- ✓ Privacy w/Bunk Room Door and Master Bedroom Door
- ✓ Large U-Shape Dinette
- ✓ Rack and Pinion Super Slide w/Dinette and Sofa
- ✓ Living Room 12V 2-Way Maxxair Vent Fan
- ✓ Folding Cube Futon in the Bunk Room
- ✓ 6 ft. 9 in. Interior Height
- ✓ 18' Awning
- ✓ Full Master Bedroom Wall w/Walk Around Queen Bed
- ✓ Full Length Nightstands with Outlets and USB's